

AREA STATEMENT

S.NO	DIFFERENT USES	IN ACRES
1	TOTAL AREA UNDER SCHEME	134.66
2	TO BE PLANNED LATER	4.21
3	NET PLANNED AREA	130.45
4	AREA UNDER INDUSTRIAL PLOTS	81.87
5	AREA UNDER PUBLIC UTILITIES	8.06
6	AREA UNDER GREEN BELT	3.55
7	AREA UNDER ELECTRIC SUB-STATION	1.47
8	AREA UNDER MULTIPLEX	0.49
9	AREA UNDER BUDGETED HOTEL	1.20
10	NET AREA FIRE STATION	0.66
11	AREA UNDER ESI DISPENSARY	1.20
12	AREA UNDER COMMUNITY CENTRE	0.88
13	AREA ALLOTTED TO BSNL	0.46
14	AREA UNDER SCO'S 6m x 24m	0.57
15	AREA UNDER BOOTHS 2.75m x 8.25m	0.15
16	AREA UNDER DHABA SITES	0.03
17	AREA UNDER WIEGH BRIDGE	0.12
18	AREA UNDER CONV. SHOPPING, BANK & POST OFFICE	0.42
19	AREA UNDER OFFICE COMPLEX	1.38
20	AREA UNDER OPEN SPACES, PARKING AND ROADS	27.94

DETAIL OF PLOTS

S.NO.	CATEGORY	AREA (Sqm.)	NO. OF PLOTS
1	45 X 106.4	4788	7
2	45 X 90	4050	26
3	-----	8247.05	01
4	33.7 X 120	4047	01
5	30 X 60	1800	44
6	22.5 X 45	1012.5	58
7	15 X 30	450	94
Total		TOTAL	231

DETAILS OF SHOPS

S.NO	CATEGORY	AREA (Sqm.)	NO. OF PLOTS
1	6m x24m (SCO'S)	144.00	16
2	2.75m x8.25m (BOOTHS)	22.69	27
3	6m x24m	45.37	02
4	3m x3m	9.00	10
TOTAL			55

LEGEND

- ALLOTTED PLOTS
- VACANT PLOT

NOTES :-

- THIS DRAWING SUPERCEDES ALREADY APPROVED DRG. NO. HSIIDC/IPD/378, DATED :-11-03-10.
- THE SITE FOR 66 KV SUB STATION MEASURING 120m X 100m i.e. 2.97 ACRES HAVE BEEN CARVED OUT OF SITE RESERVED FOR UTILITIES AS APPROVED BY MD HSIIDC ON 11/6/12 ON FILE NO. 55-C AT N.P. 109.
- SITE OF 66 KV HAVE BEEN APPROVED BY MD HSIIDC ON 11-04-13 AT THE SAME LOCATION BY SHIFTING IT 60M.

SCALE :-

DRG. NO. HSIIDC/IPD/788, DATED :- 03/9/13

DRAWN BY:- SURINDER PRASHAR (-SD-)

A.T.P. :- ANINDERBIR KAUR GREWAL (-SD-)

D.T.P.:-

C.T.P.:- DILBAG SINGH SIHAG (-SD-)

(-SD-)
 DIRECTOR CONTROLLED AREA CUM M.D. HSIIDC:- TARUN BAJAJ

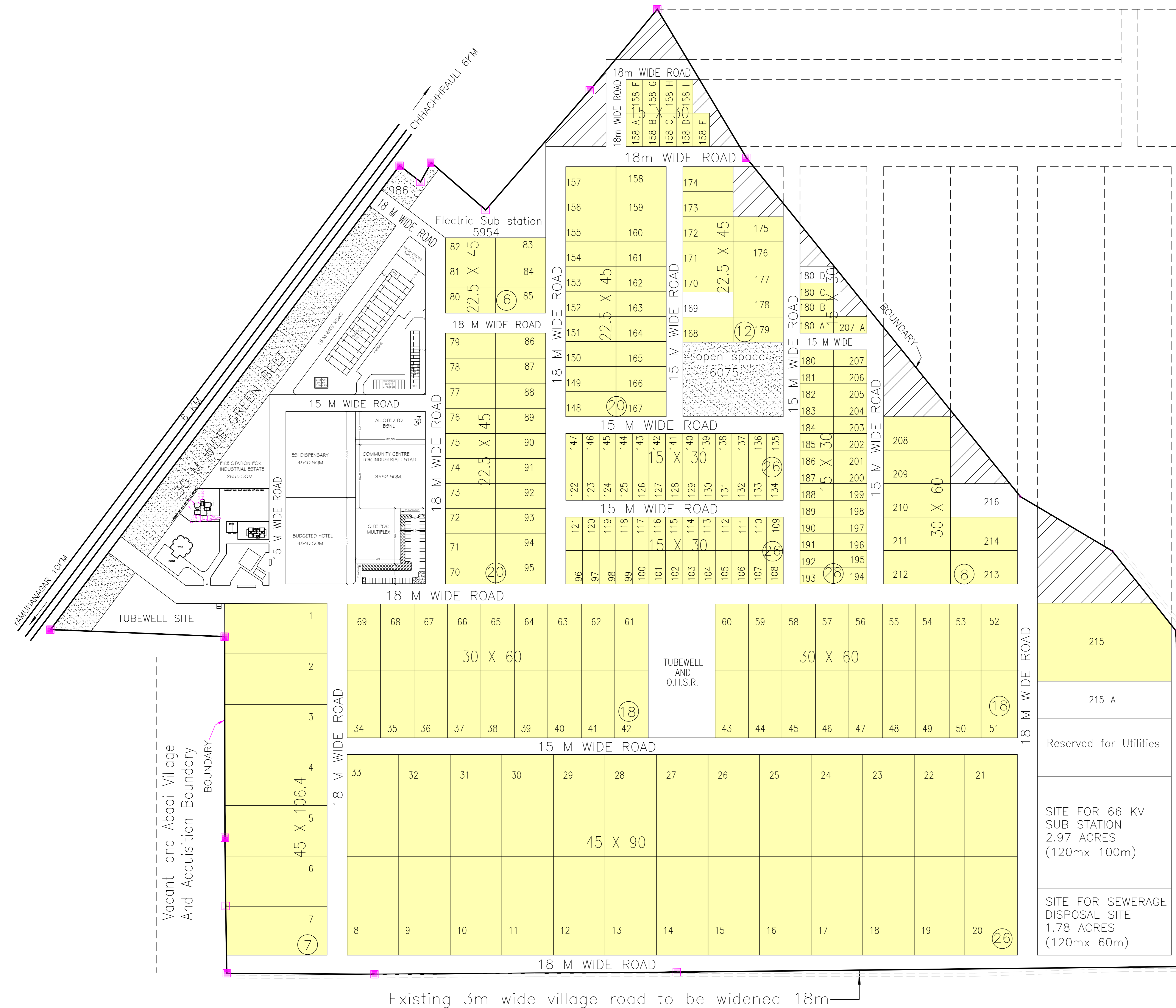

Existing 3m wide village road to be widened 18m